

THE  
**FREDERICK**  
 | CONDOMINIUMS |

THE  
**GLADSTONE**

1 BEDROOM + FLEX  
 Interior: 614 sq.ft.

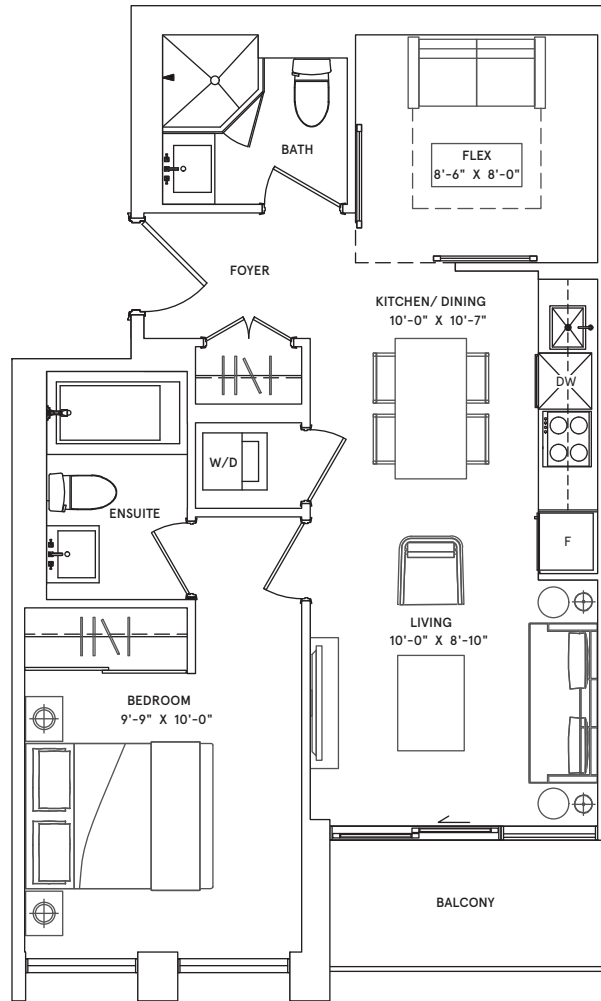

NORTH  
 KEY PLAN TYPICAL  
 FLOORS 10-28

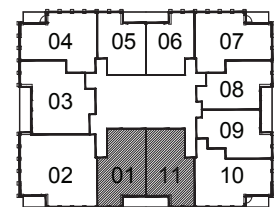

Dimensions, specifications, layouts (including but not limited to tile patterns), window sizes, mullions, fixture representation, appliance and fixture locations, and materials are approximate only, may vary, and are subject to changes without notice as provided in the Agreement of Purchase and Sale. Plans may be reversed. Wall thickness will vary with floor levels reducing room dimensions accordingly. Actual usable floor space may vary from the stated floor area. Measurements of rooms set forth on any floor plan are generally taken at the greatest points of each given room and centre line of windows (as if the room were perfectly rectangular). Furniture is not included. Furniture shown on terrace spaces should be secured for safety. Prices are subject to change without notice. E. & O.E. Plans are not to scale. For more information on the method used for calculating floor area of any unit, reference should be made to Builder Bulletin NO. 22 published by Tarion.

THE  
**FREDERICK**  
 | CONDOMINIUMS |

THE  
**ASTAIRE**

2 BEDROOM  
 Interior: 997sq.ft.

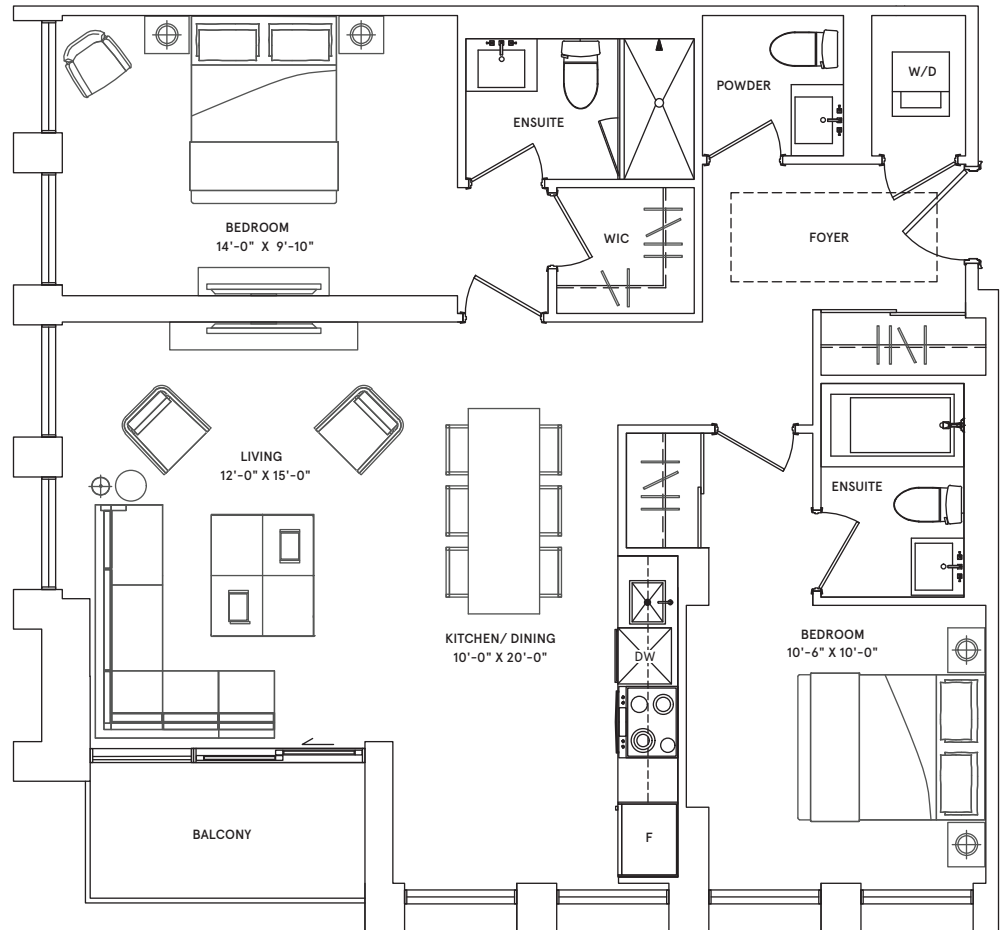

NORTH  
 KEY PLAN TYPICAL  
 FLOORS 10-28



Dimensions, specifications, layouts (including but not limited to tile patterns), window sizes, mullions, fixture representation, appliance and fixture locations, and materials are approximate only, may vary, and are subject to changes without notice as provided in the Agreement of Purchase and Sale. Plans may be reversed. Wall thickness will vary with floor levels reducing room dimensions accordingly. Actual usable floor space may vary from the stated floor area. Measurements of rooms set forth on any floor plan are generally taken at the greatest points of each given room and centre line of windows (as if the room were perfectly rectangular). Furniture is not included. Furniture shown on terrace spaces should be secured for safety. Prices are subject to change without notice. E. & O.E. Plans are not to scale. For more information on the method used for calculating floor area of any unit, reference should be made to Builder Bulletin NO. 22 published by Tarion.

THE  
**FREDERICK**  
 | CONDOMINIUMS |

THE  
**PERRY**

2 BEDROOM

Interior: 825 sq.ft.

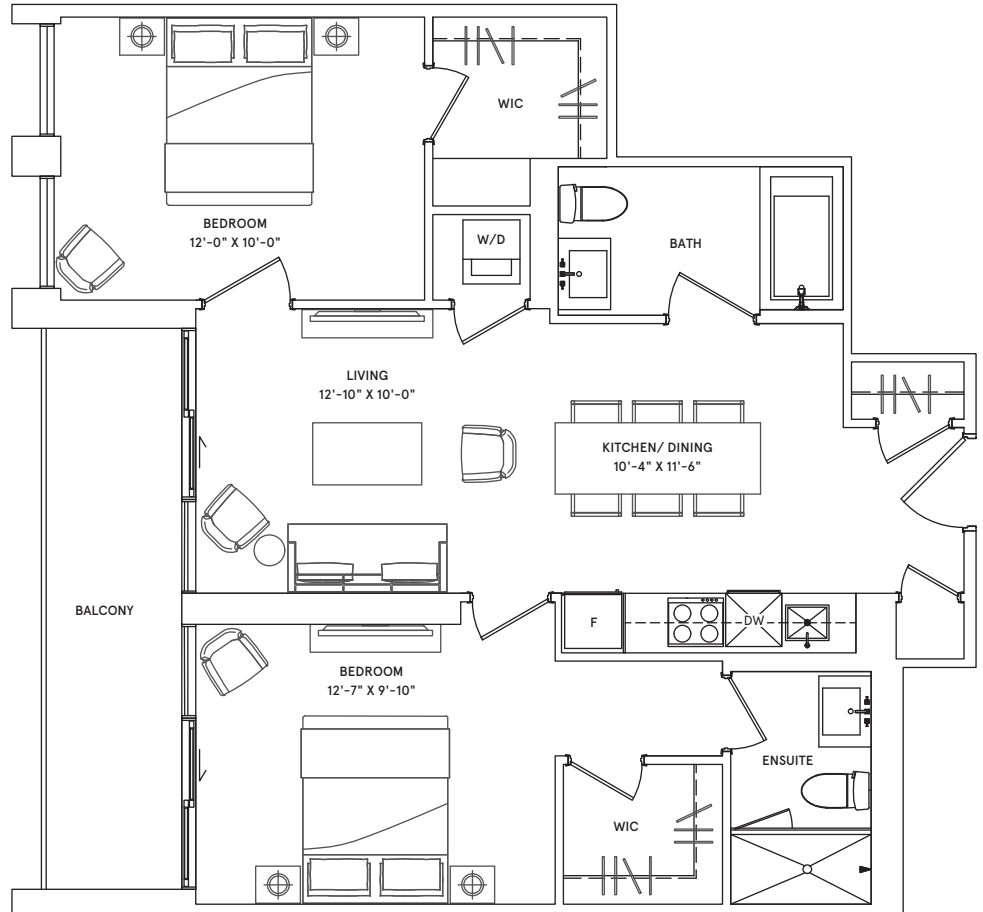

NORTH  
 KEY PLAN TYPICAL  
 FLOORS 10-28

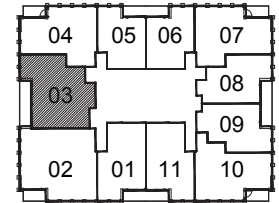

Dimensions, specifications, layouts (including but not limited to tile patterns), window sizes, mullions, fixture representation, appliance and fixture locations, and materials are approximate only, may vary, and are subject to changes without notice as provided in the Agreement of Purchase and Sale. Plans may be reversed. Wall thickness will vary with floor levels reducing room dimensions accordingly. Actual usable floor space may vary from the stated floor area. Measurements of rooms set forth on any floor plan are generally taken at the greatest points of each given room and centre line of windows (as if the room were perfectly rectangular). Furniture is not included. Furniture shown on terrace spaces should be secured for safety. Prices are subject to change without notice. E. & O.E. Plans are not to scale. For more information on the method used for calculating floor area of any unit, reference should be made to Builder Bulletin NO. 22 published by Tarion.



Building Excellence

THE  
**FREDERICK**  
 | CONDOMINIUMS |

THE  
**MERCURY**

2 BEDROOM  
 Interior: 715 sq.ft.

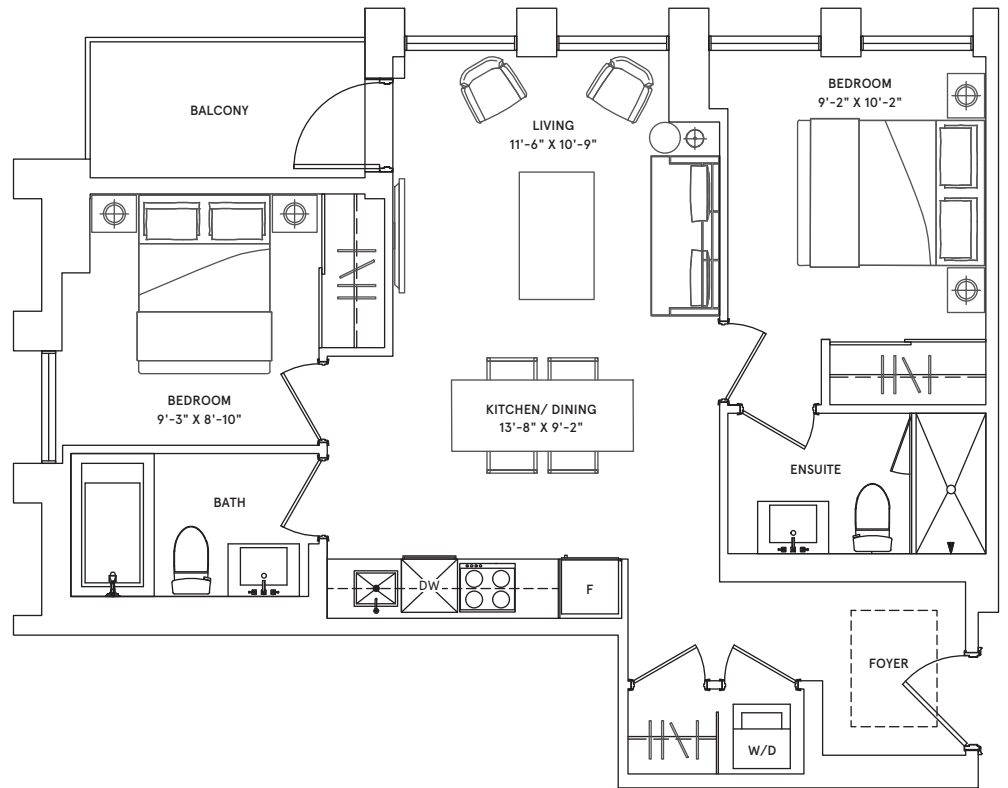

NORTH  
 KEY PLAN TYPICAL  
 FLOORS 10-28

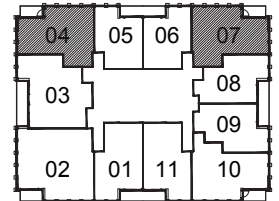

Dimensions, specifications, layouts (including but not limited to tile patterns), window sizes, mullions, fixture representation, appliance and fixture locations, and materials are approximate only, may vary, and are subject to changes without notice as provided in the Agreement of Purchase and Sale. Plans may be reversed. Wall thickness will vary with floor levels reducing room dimensions accordingly. Actual usable floor space may vary from the stated floor area. Measurements of rooms set forth on any floor plan are generally taken at the greatest points of each given room and centre line of windows (as if the room were perfectly rectangular). Furniture is not included. Furniture shown on terrace spaces should be secured for safety. Prices are subject to change without notice. E. & O.E. Plans are not to scale. For more information on the method used for calculating floor area of any unit, reference should be made to Builder Bulletin NO. 22 published by Tarion.

THE  
**FREDERICK**  
 | CONDOMINIUMS |

THE  
 COUPLES

1 BEDROOM

Interior: 498 sq.ft.

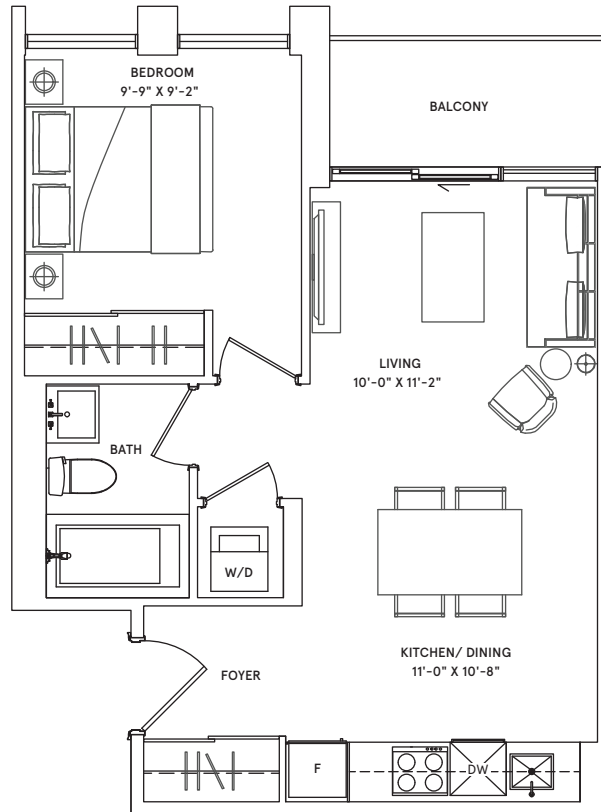

NORTH  
 KEY PLAN TYPICAL  
 FLOORS 10-28

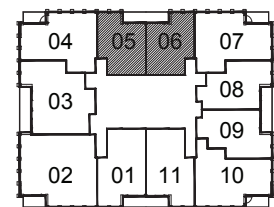

Dimensions, specifications, layouts (including but not limited to tile patterns), window sizes, mullions, fixture representation, appliance and fixture locations, and materials are approximate only, may vary, and are subject to changes without notice as provided in the Agreement of Purchase and Sale. Plans may be reversed. Wall thickness will vary with floor levels reducing room dimensions accordingly. Actual usable floor space may vary from the stated floor area. Measurements of rooms set forth on any floor plan are generally taken at the greatest points of each given room and centre line of windows (as if the room were perfectly rectangular). Furniture is not included. Furniture shown on terrace spaces should be secured for safety. Prices are subject to change without notice. E. & O.E. Plans are not to scale. For more information on the method used for calculating floor area of any unit, reference should be made to Builder Bulletin NO. 22 published by Tarion.



Building Excellence

THE  
**FREDERICK**  
 | CONDOMINIUMS |

THE  
**HIGHMORE**

1 BEDROOM + DEN  
 Interior: 546 sq.ft.

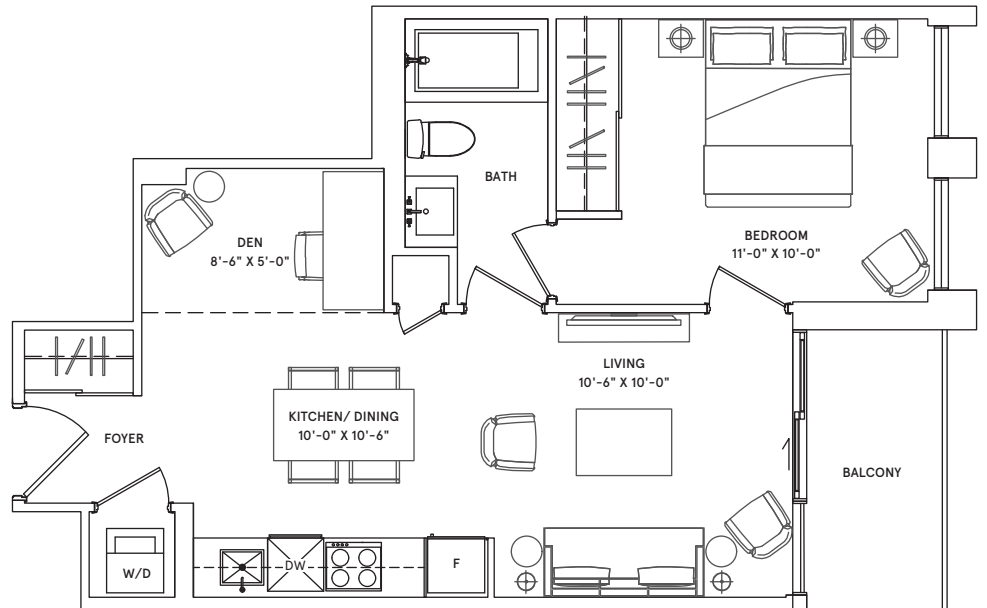

NORTH  
 KEY PLAN TYPICAL  
 FLOORS 10-28

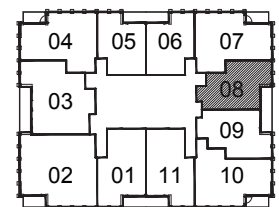

Dimensions, specifications, layouts (including but not limited to tile patterns), window sizes, mullions, fixture representation, appliance and fixture locations, and materials are approximate only, may vary, and are subject to changes without notice as provided in the Agreement of Purchase and Sale. Plans may be reversed. Wall thickness will vary with floor levels reducing room dimensions accordingly. Actual usable floor space may vary from the stated floor area. Measurements of rooms set forth on any floor plan are generally taken at the greatest points of each given room and centre line of windows (as if the room were perfectly rectangular). Furniture is not included. Furniture shown on terrace spaces should be secured for safety. Prices are subject to change without notice. E. & O.E. Plans are not to scale. For more information on the method used for calculating floor area of any unit, reference should be made to Builder Bulletin NO. 22 published by Tarion.

THE  
**FREDERICK**  
 | CONDOMINIUMS |

THE  
**COLE**

1 BEDROOM + DEN  
 Interior: 562 sq.ft.

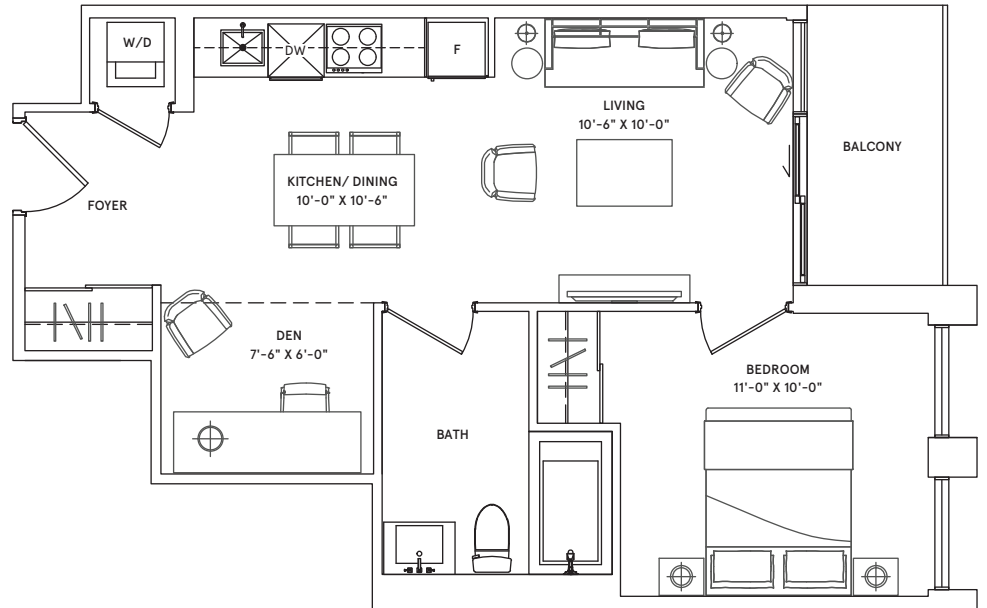

NORTH  
 KEY PLAN TYPICAL  
 FLOORS 10-28

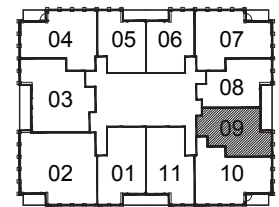

Dimensions, specifications, layouts (including but not limited to tile patterns), window sizes, mullions, fixture representation, appliance and fixture locations, and materials are approximate only, may vary, and are subject to changes without notice as provided in the Agreement of Purchase and Sale. Plans may be reversed. Wall thickness will vary with floor levels reducing room dimensions accordingly. Actual usable floor space may vary from the stated floor area. Measurements of rooms set forth on any floor plan are generally taken at the greatest points of each given room and centre line of windows (as if the room were perfectly rectangular). Furniture is not included. Furniture shown on terrace spaces should be secured for safety. Prices are subject to change without notice. E. & O.E. Plans are not to scale. For more information on the method used for calculating floor area of any unit, reference should be made to Builder Bulletin NO. 22 published by Tarion.

THE  
**FREDERICK**  
 | CONDOMINIUMS |

THE  
**BANTING**

2 BEDROOM  
 Interior: 725 sq.ft.

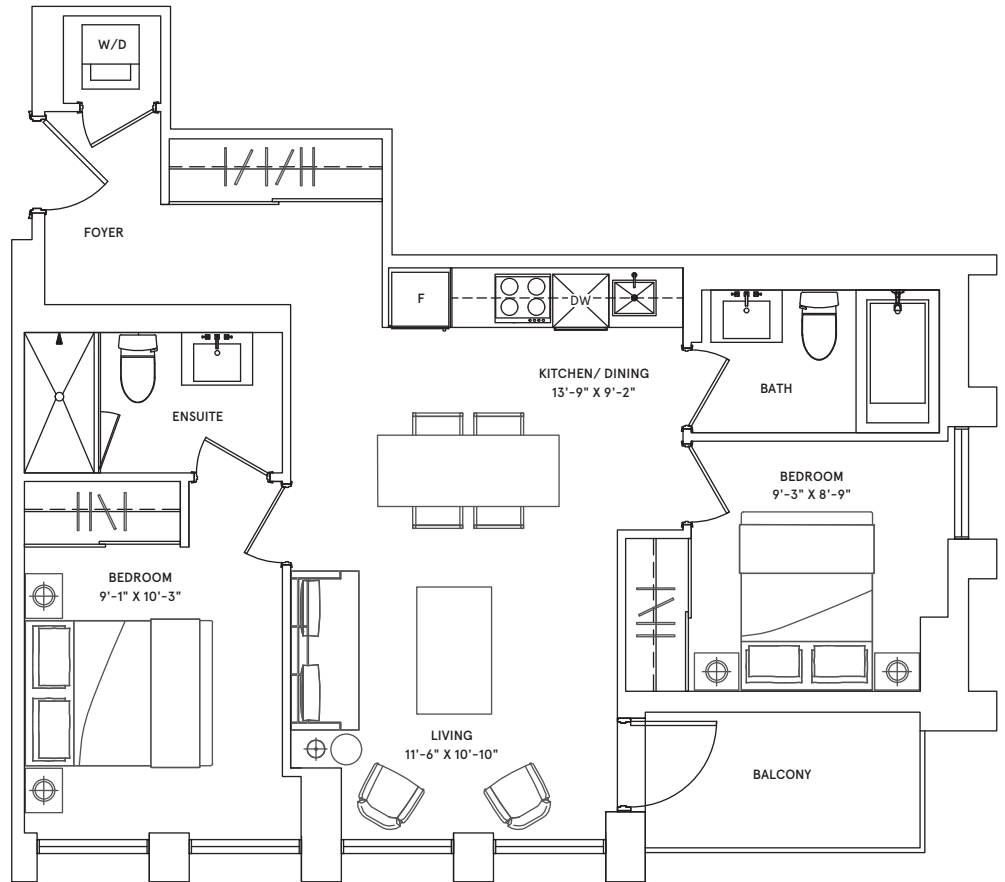

NORTH  
 KEY PLAN TYPICAL  
 FLOORS 10-28

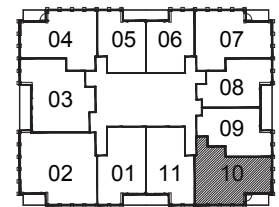

Dimensions, specifications, layouts (including but not limited to tile patterns), window sizes, mullions, fixture representation, appliance and fixture locations, and materials are approximate only, may vary, and are subject to changes without notice as provided in the Agreement of Purchase and Sale. Plans may be reversed. Wall thickness will vary with floor levels reducing room dimensions accordingly. Actual usable floor space may vary from the stated floor area. Measurements of rooms set forth on any floor plan are generally taken at the greatest points of each given room and centre line of windows (as if the room were perfectly rectangular). Furniture is not included. Furniture shown on terrace spaces should be secured for safety. Prices are subject to change without notice. E. & O.E. Plans are not to scale. For more information on the method used for calculating floor area of any unit, reference should be made to Builder Bulletin NO. 22 published by Tarion.



# Why PreCon



*Calltoddsmith.ca*  
I'll Be Your  
RE-Location Advocate

Todd Smith, REALTOR®  
Civil Engineering Technologist  
ABR | SRS | CNE | SRES | SRS | RENE



**RE/MAX**  
HALLMARK REALTY LTD.  
416.731.8956



**RE/MAX**  
PROFESSIONALS-SJ  
506.927.0070



**RE/MAX**  
NOVA  
902.989.2567

Uniquely licensed salesperson with all three independently owned & operated brokerages above. For more information email: [todd@calltoddsmith.ca](mailto:todd@calltoddsmith.ca)

[todd@calltoddsmith.ca](mailto:todd@calltoddsmith.ca)